

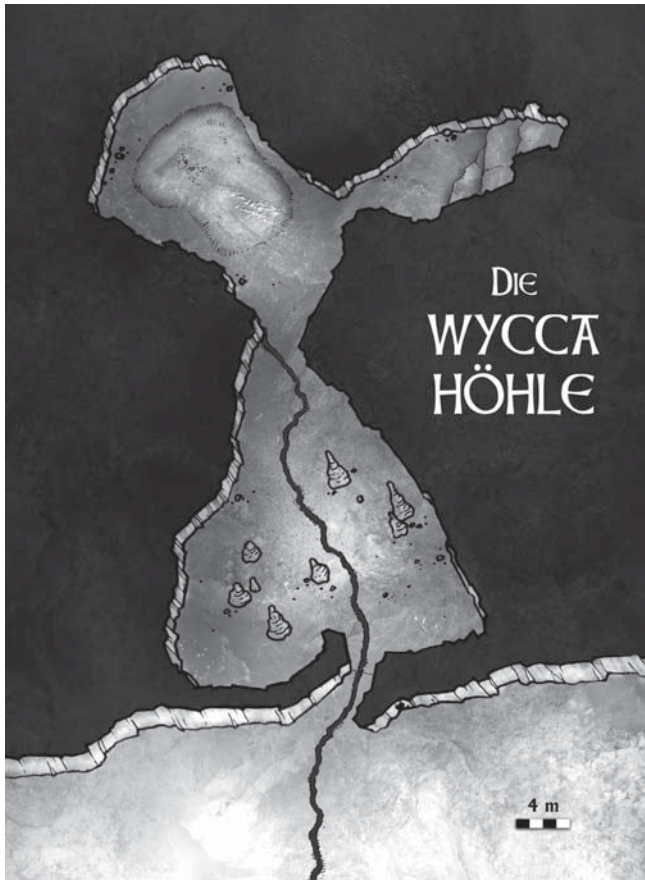

*Die Ortschaft Swanaham*



*Die Ortschaft Wold Harwor*



*Die Wyccahöhle bei Swanaham*

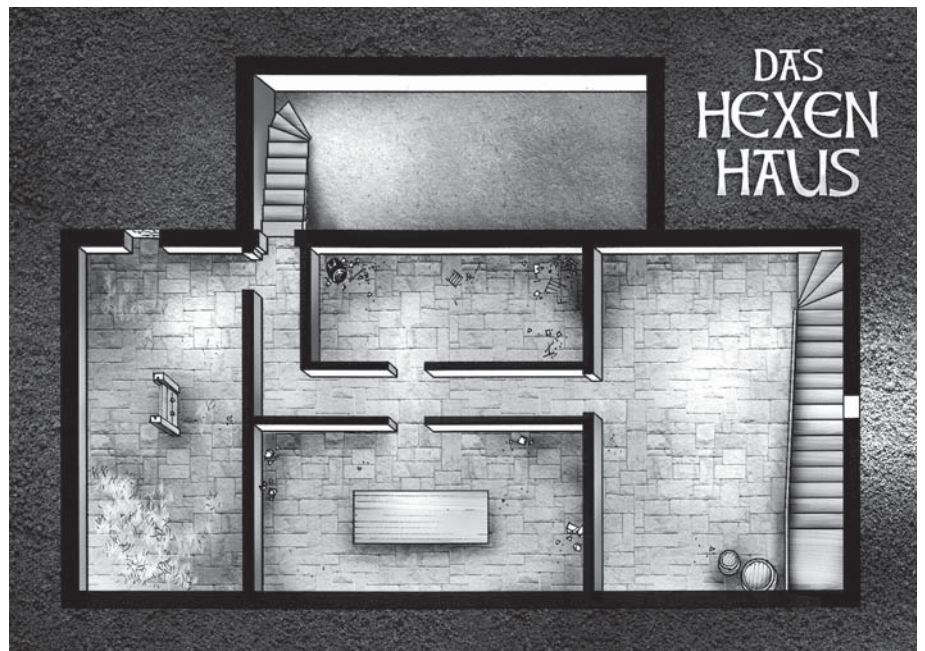

*Das Hexenhaus in Crossing*

# SAINGORN

6 m

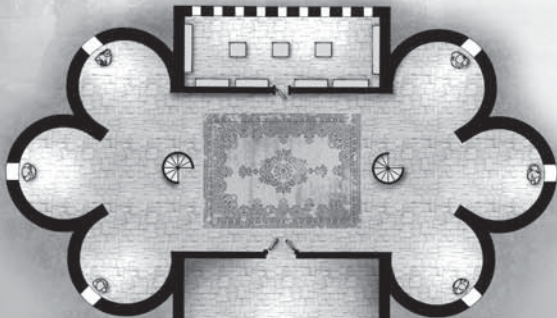
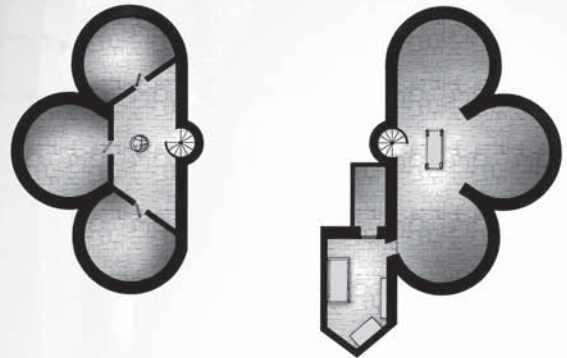

Kräuter-  
garten

Bau-  
gerüst

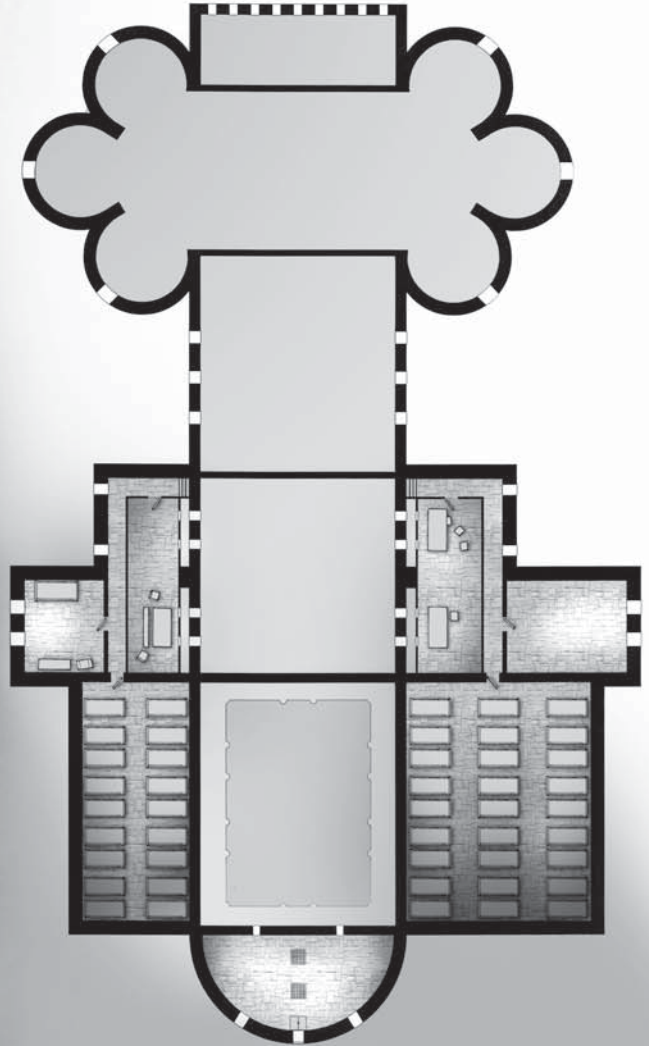

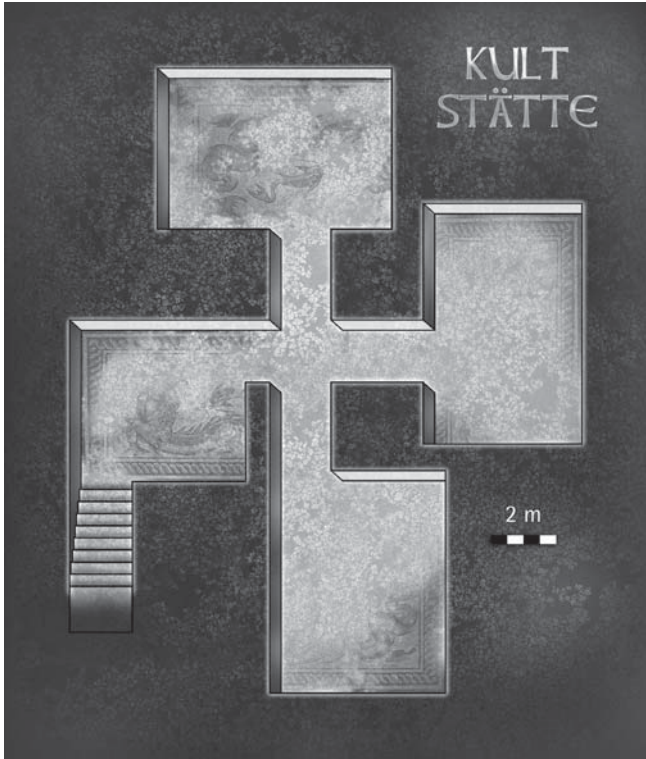

*Die Blutquelle, Kultstätte Lyakons*



*Statue Lyakons in der Kultstätte*



Stadtplan von Crossing



*Dem Fichtenlachs auf der Spur*



*Der gestrandete Fichtenlachs*